

GLOUCESTER COUNTY

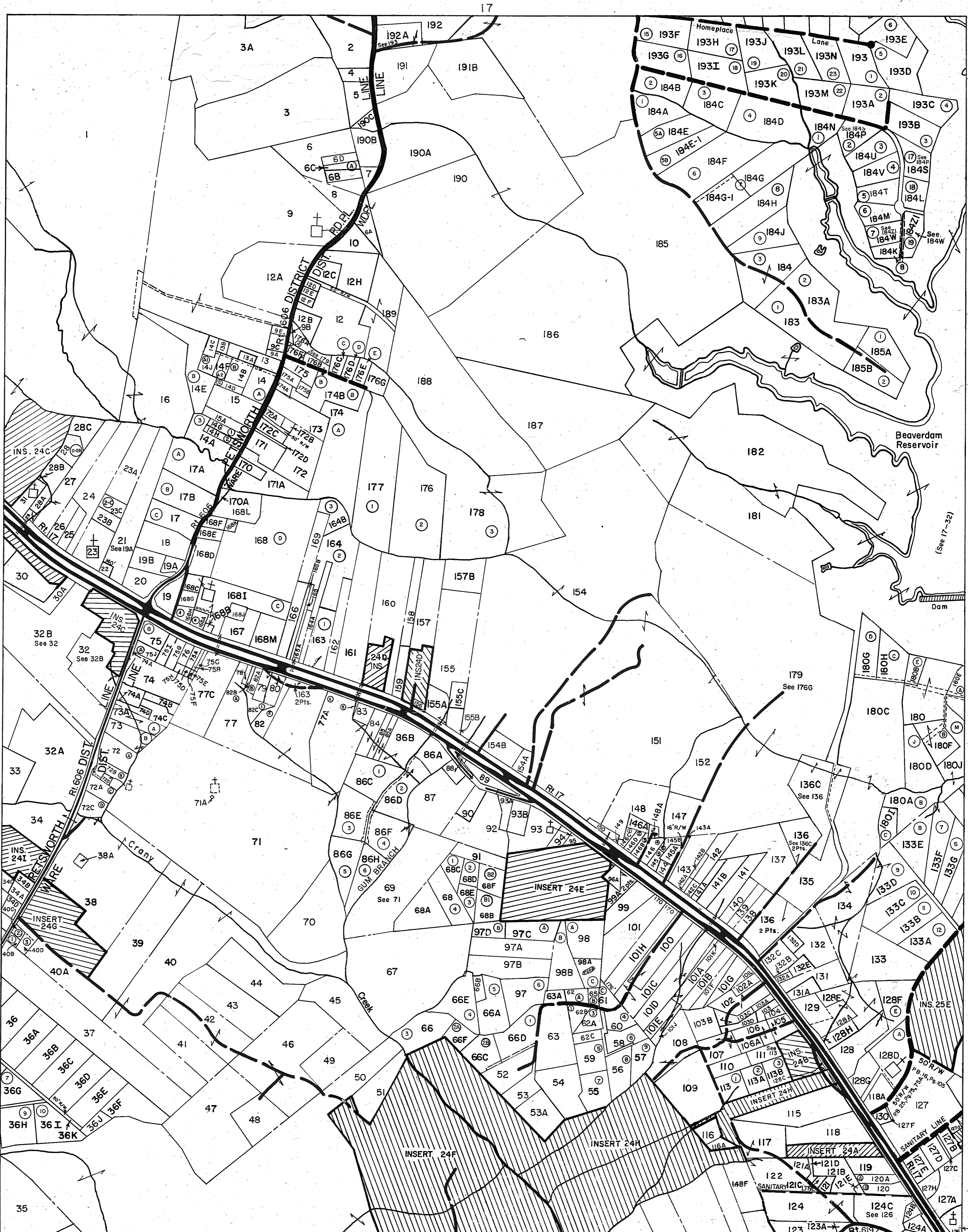

PREPARED BY - THE DEPARTMENT OF TAXATION, DIVISION OF APPRAISALS & MAPPING

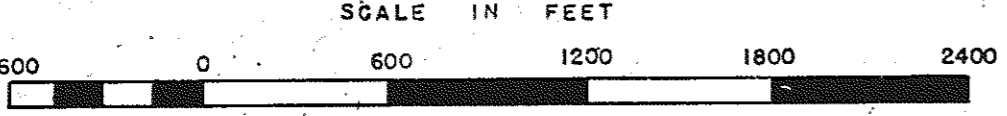

PETSWORTH & WARE DISTRICTS

SECTION 24

REV. 12/75
REV. 6/57, 1/63; 9/8/71, 3/80, 12/31/83/84/85/86/87/88/89/90/91/92/94/95/96/97/98/99/00/01/02/03/04/05/06/07/08/09/10/11/12/13/15/16