

GLOUCESTER COUNTY

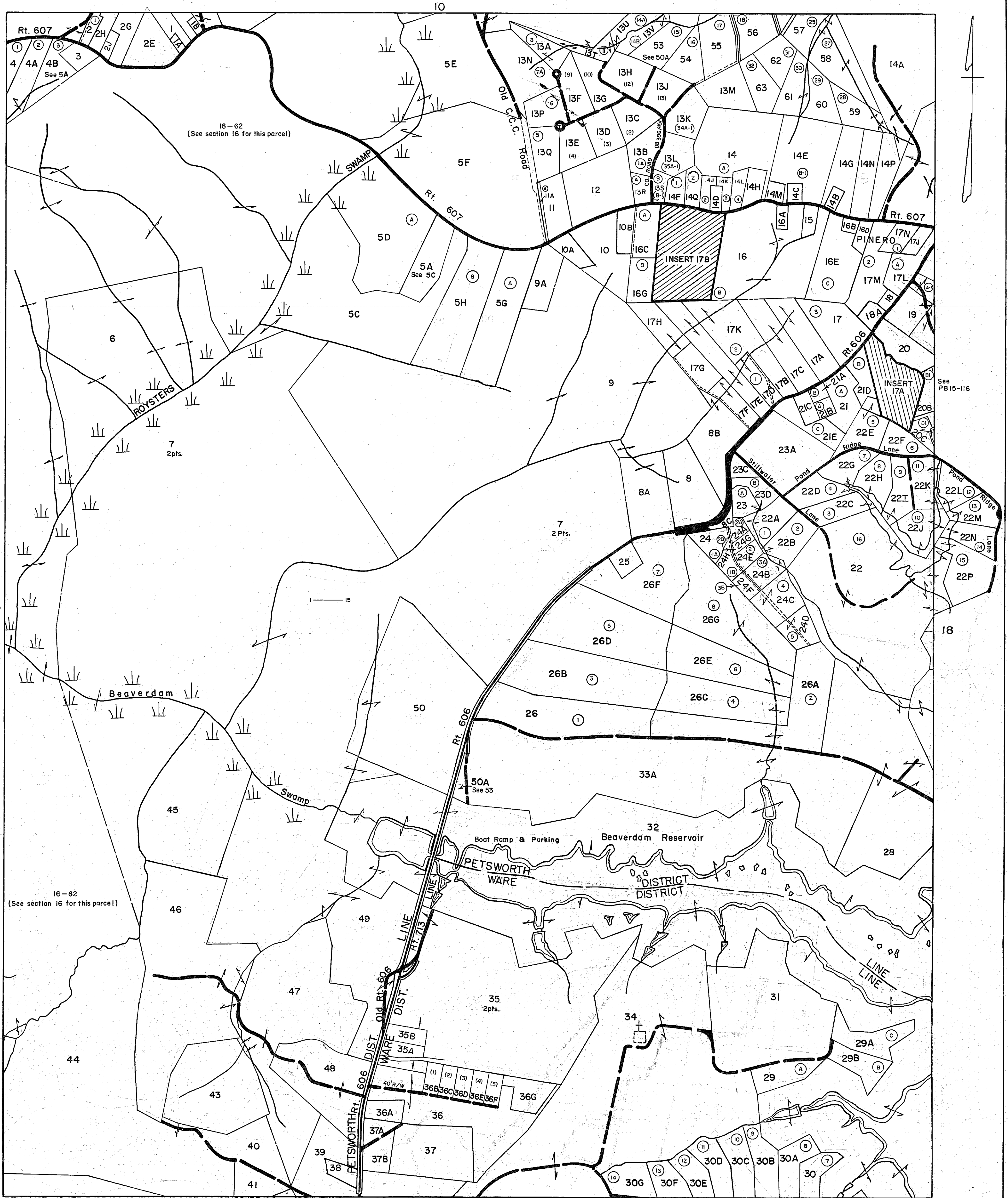

REV. 1/63 ; 12/75; 3/25/80; 12/31/83/84/85/86/87/88/89/90/91/92/93/94/95 / 97/98/99/00/01/02/4 / 03/04/06/07/08/09/10/13/14/16



PETWORTH & WARE DISTRICTS

VIRGINIA STATE DEPARTMENT OF TAXATION, DIVISION OF REAL ESTATE APPRAISAL AND MAPPING

SECTION 17