

GLOUCESTER COUNTY SURVEY MARK DATA SHEET

STATION NO.

101

HORIZONTAL DATA :		
VA. STATE PLANE COORD. - SOUTH ZONE (NAD 1983)		
UNITS	EASTING (X)	NORTHING (Y)
METERS	3670917.238	1114567.043
U.S. SURVEY FT.	12043667.638	3656675.899
LATITUDE (DMS)		37 20 59.55286
LONGITUDE (DMS)		76 34 14.58928
SCALE FACTOR		0.99994545
CONVERGENCE \sphericalangle (DMS)		1 10 15.34
VERTICAL DATA :		
REF. TO NATL. GEOD. VERT. DATUM (1988)		
UNITS	STATION ELEVATION	
METERS	10.45	
U.S. SURVEY FT.	34.28	

STATION DESCRIPTION :

DISTRICT : PETSWORTH

A 3-1/4" ALUMINUM DISK MONUMENT SET APPROXIMATELY FLUSH WITH THE GROUND STAMPED STATION NO. 101. TO REACH: FROM THE INTERSECTION OF U. S. ROUTE 17 AND STATE ROUTE 614 AT WHITE MARSH, GO ABOUT 2.7 MILES NORTHWEST ON STATE ROUTE 614 TO THE INTERSECTION OF STATE ROUTE 614 AND STATE ROUTE 632; GO ABOUT 0.8 MILE SOUTHWEST ON STATE ROUTE 632 TO MONUMENT SITE.

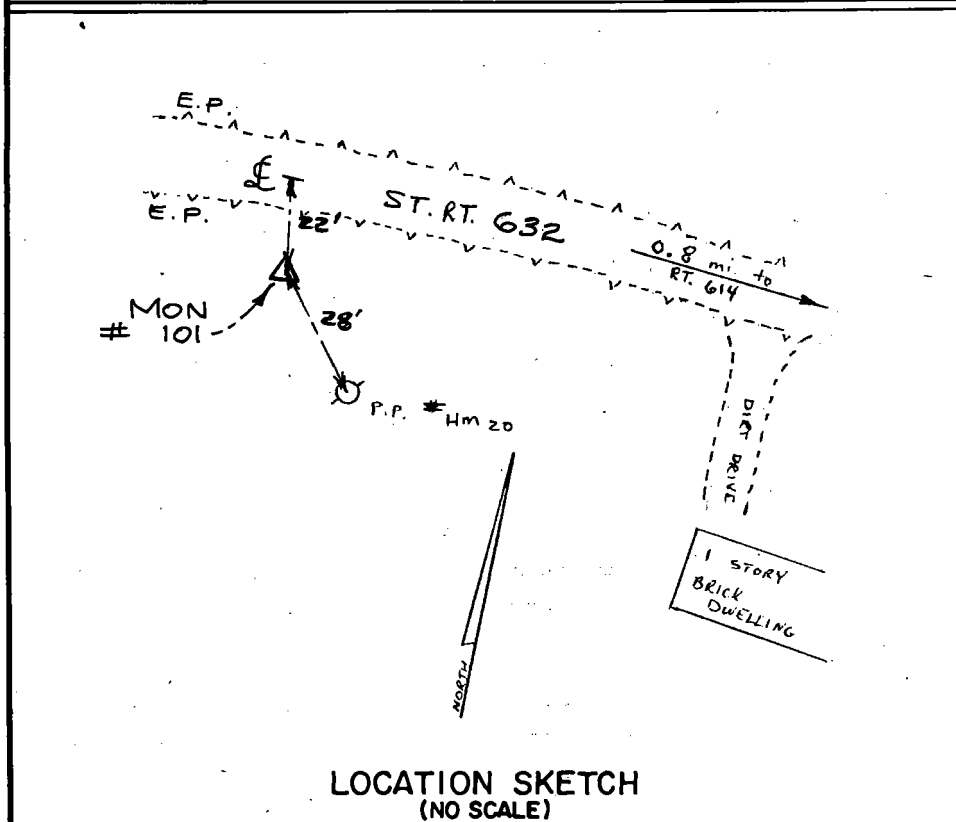

LOCATION SKETCH
(NO SCALE)

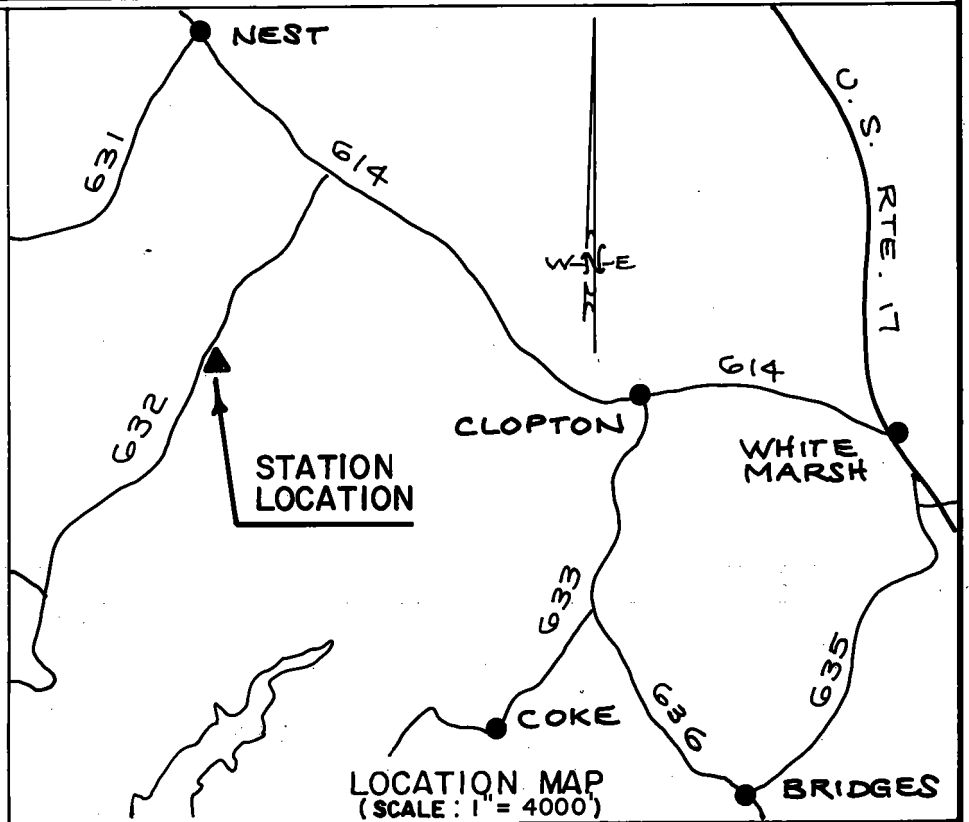

LOCATION MAP
(SCALE: 1" = 4000')

DATE: JANUARY, 1992

NOTE: USERS OF MONUMENTS LOCATED ON PRIVATE PROPERTY
MUST OBTAIN LAND OWNERS PERMISSION BEFORE ENTERING



Dawson & Phillips, P.C.

CERTIFIED LAND SURVEYORS
(604) 693-2993