

GLOUCESTER COUNTY SURVEY MARK DATA SHEET

STATION NO.
043

HORIZONTAL DATA :		
VA. STATE PLANE COORD. - SOUTH ZONE (NAD 1983)		
UNITS	EASTING (X)	NORTHING (Y)
METERS	3667922.272	1120057.380
U.S. SURVEY FT.	12033841.654	3674721.588
LATITUDE (DMS)		37 23 59.90845
LONGITUDE (DMS)		76 36 11.76986
SCALE FACTOR		0.99994556
CONVERGENCE \sphericalangle (DMS)		1 9 4.22
VERTICAL DATA :		
REF. TO NATL. GEOD. VERT. DATUM (1988)		
UNITS	STATION ELEVATION	
METERS	28.01	
U.S. SURVEY FT.	91.90	

STATION DESCRIPTION :

DISTRICT : PETSORTH

A 3-1/4" ALUMINUM DISK MONUMENT SET APPROXIMATELY FLUSH WITH THE GROUND STAMPED STATION NO. 043. TO REACH: FROM THE INTERSECTION OF U. S. ROUTE 17 AND STATE ROUTE 606 AT ARK, GO ABOUT 2.7 MILES WEST ON STATE ROUTE 606 TO THE INTERSECTION OF STATE ROUTE 614; GO ABOUT 0.5 MILE SOUTH ON STATE ROUTE 614 TO MONUMENT SITE AT THE INTERSECTION OF STATE ROUTE 614 AND STATE ROUTE 618.

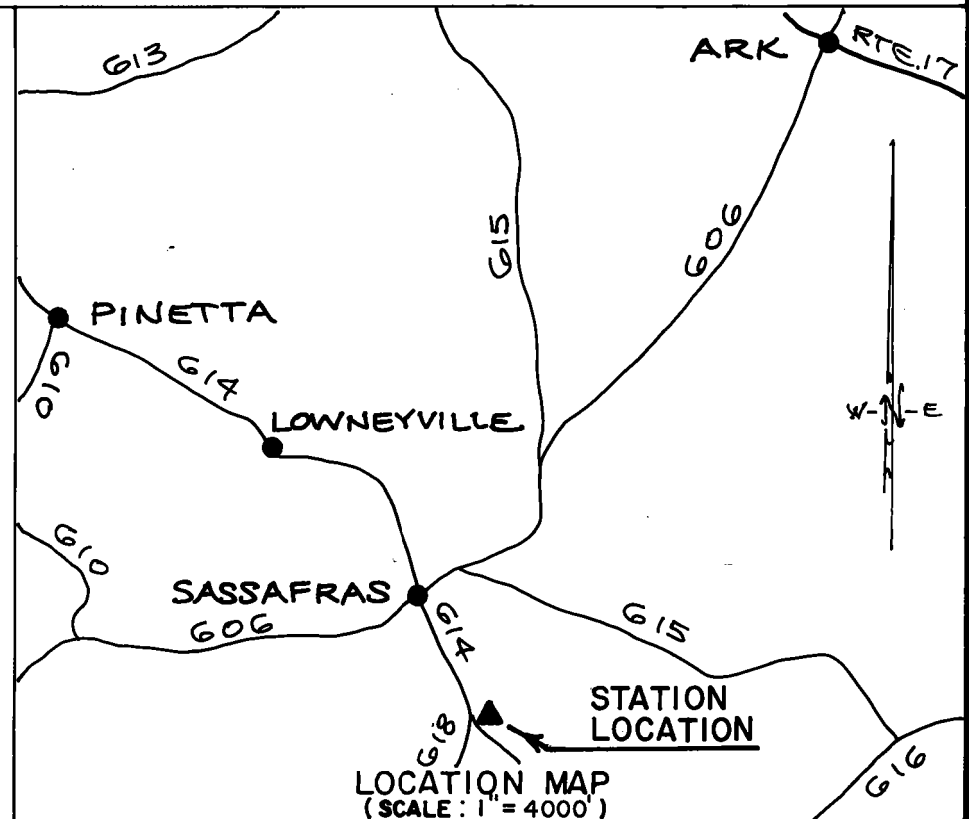
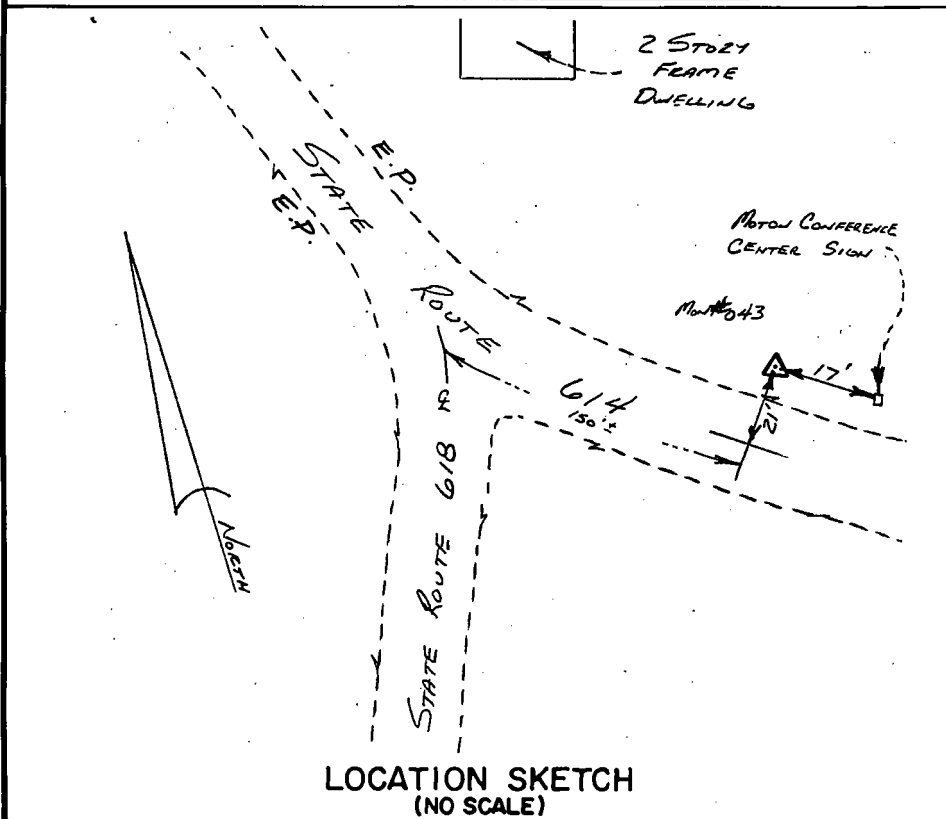

DATE: JANUARY, 1992

NOTE: USERS OF MONUMENTS LOCATED ON PRIVATE PROPERTY
MUST OBTAIN LAND OWNERS PERMISSION BEFORE ENTERING



DAWSON & PHILLIPS, P.C.
CERTIFIED LAND SURVEYORS
(804) 693-2993