

GLOUCESTER COUNTY SURVEY MARK DATA SHEET

STATION NO.
026

HORIZONTAL DATA :		
VA. STATE PLANE COORD. - SOUTH ZONE (NAD 1983)		
UNITS	EASTING (X)	NORTHING (Y)
METERS	3675354.041	1135070.375
U.S. SURVEY FT.	12058224.050	3723976.722
LATITUDE (DMS)		37 32 1.84401
LONGITUDE (DMS)		76 30 56.82917
SCALE FACTOR		0.99994960
CONVERGENCE \sphericalangle (DMS)		1 12 15.37
VERTICAL DATA :		
REF. TO NATL. GEOD. VERT. DATUM (1988)		
UNITS	STATION ELEVATION	
METERS	23.59	
U.S. SURVEY FT.	77.38	

STATION DESCRIPTION :

DISTRICT : PETS WORTH

A 3-1/4" ALUMINUM DISK MONUMENT SET APPROXIMATELY FLUSH WITH THE GROUND STAMPED STATION NO. 026. TO REACH: FROM THE INTERSECTION OF STATE ROUTE 198 AND STATE ROUTE 601 AT CASH, GO ABOUT 1.6 MILES EAST ON STATE ROUTE 198 TO MONUMENT SITE ON SOUTH SIDE OF STATE ROUTE 198.

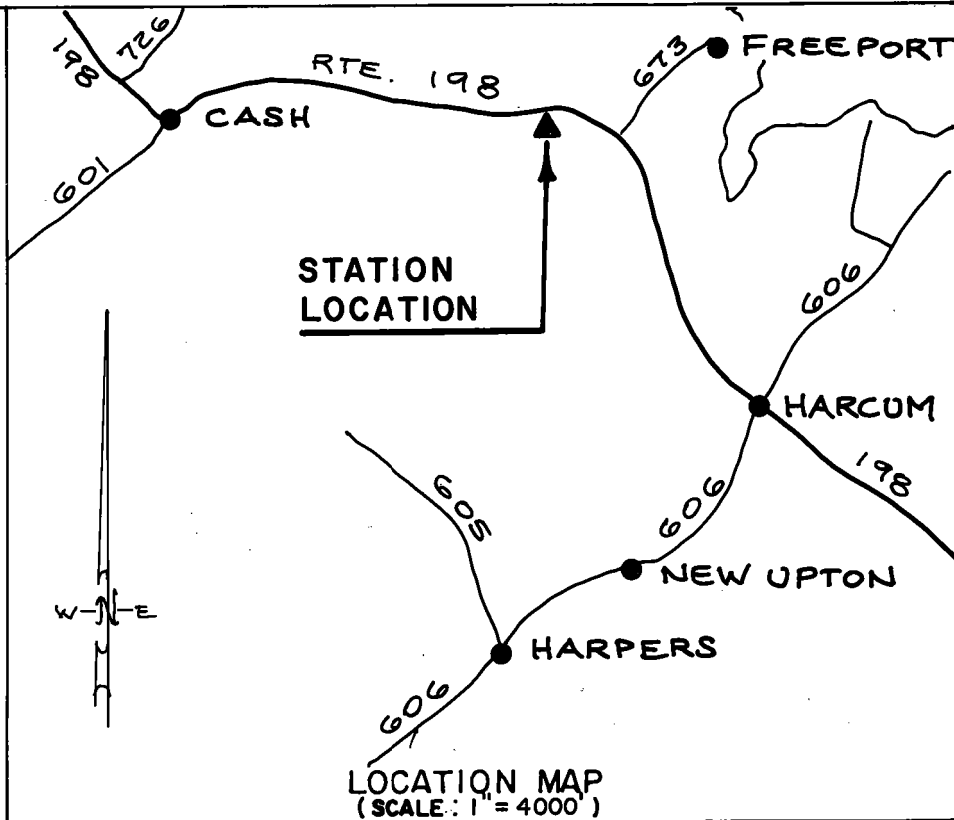
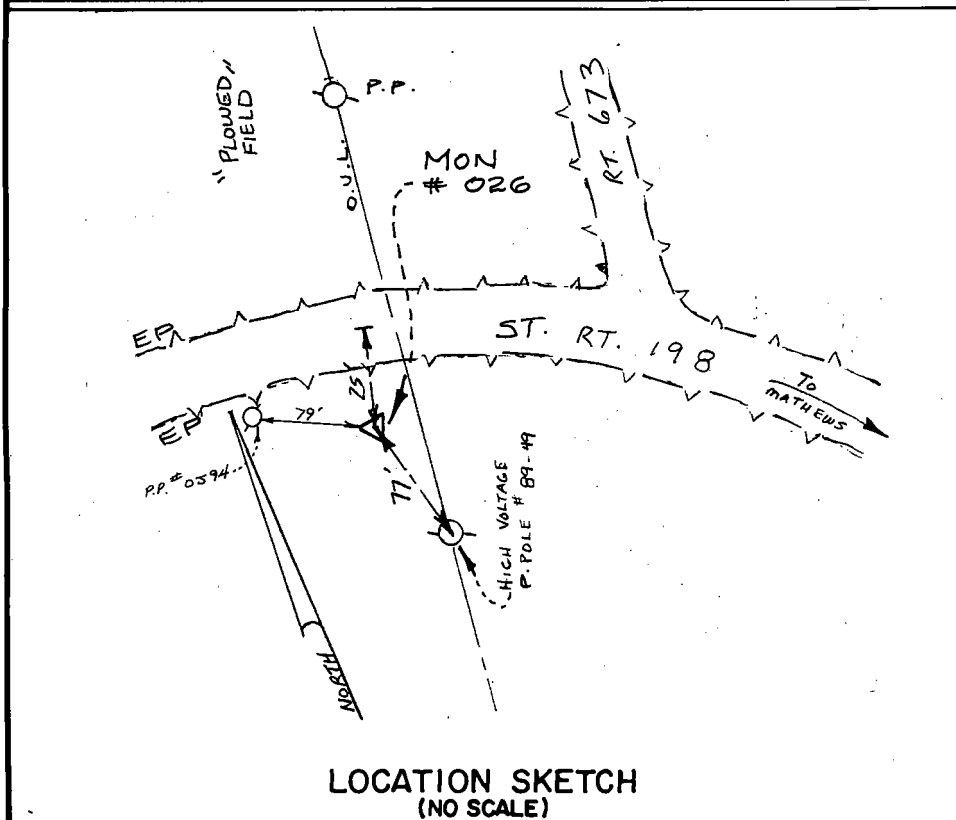

DATE: JANUARY, 1992

NOTE: USERS OF MONUMENTS LOCATED ON PRIVATE PROPERTY
MUST OBTAIN LAND OWNERS PERMISSION BEFORE ENTERING



Dawson & Phillips, P.C.
CERTIFIED LAND SURVEYORS
(804) 693-2993