

GLOUCESTER COUNTY SURVEY MARK DATA SHEET

STATION NO.
015

HORIZONTAL DATA :		
VA. STATE PLANE COORD. - SOUTH ZONE (NAD 1983)		
UNITS	EASTING (X)	NORTHING (Y)
METERS	3669836.386	1134997.315
U.S. SURVEY FT.	12040121.543	3723737.024
LATITUDE (DMS)	37 32 3.17704	
LONGITUDE (DMS)	76 34 41.59221	
SCALE FACTOR	0.99994962	
CONVERGENCE \sphericalangle (DMS)	1 9 58.95	
VERTICAL DATA :		
REF. TO NATL. GEOD. VERT. DATUM (1988)		
UNITS	STATION ELEVATION	
METERS	24.90	
U.S. SURVEY FT.	81.69	

STATION DESCRIPTION :

DISTRICT : PETSWORTH

A 3-1/4" ALUMINUM DISK MONUMENT SET APPROXIMATELY FLUSH WITH THE GROUND STAMPED STATION NO. 015. TO REACH: FROM THE INTERSECTION OF STATE ROUTE 601 AND STATE ROUTE 610 AT PAMPA, GO ABOUT 0.05 MILE NORTH ON STATE ROUTE 610 TO INTERSECTION WITH STATE ROUTE 637; PROCEED NORTHEAST ON STATE ROUTE 637 ABOUT 1.0 MILE TO MONUMENT SITE ON NORTH SIDE OF STATE ROUTE 637.

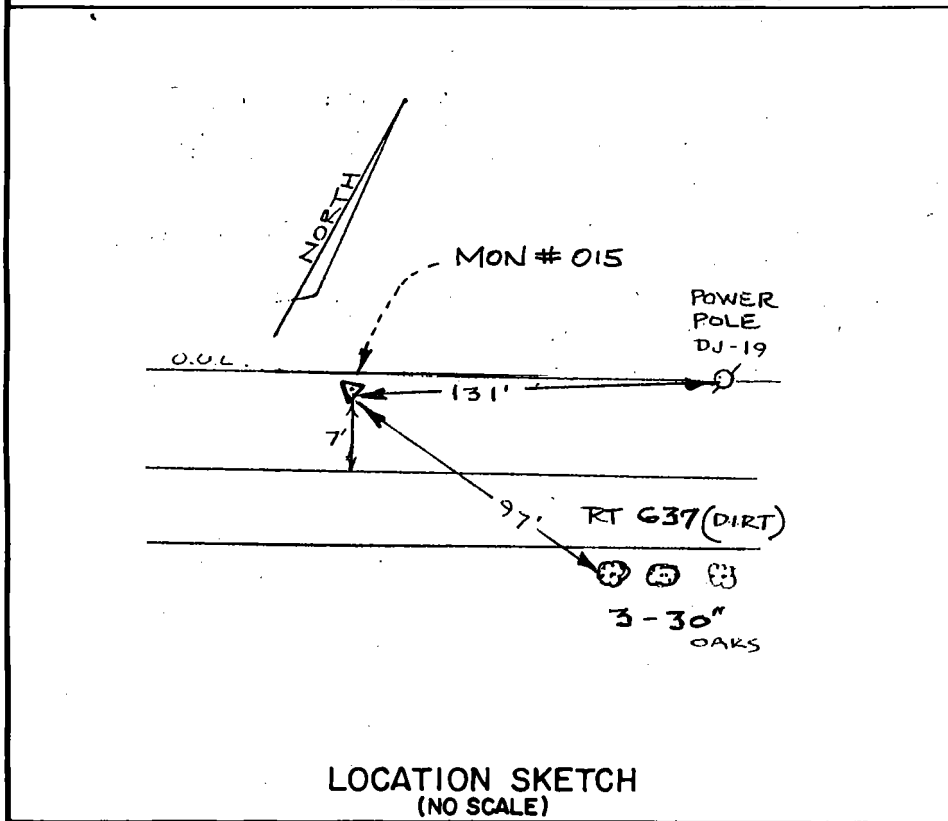

LOCATION SKETCH
(NO SCALE)

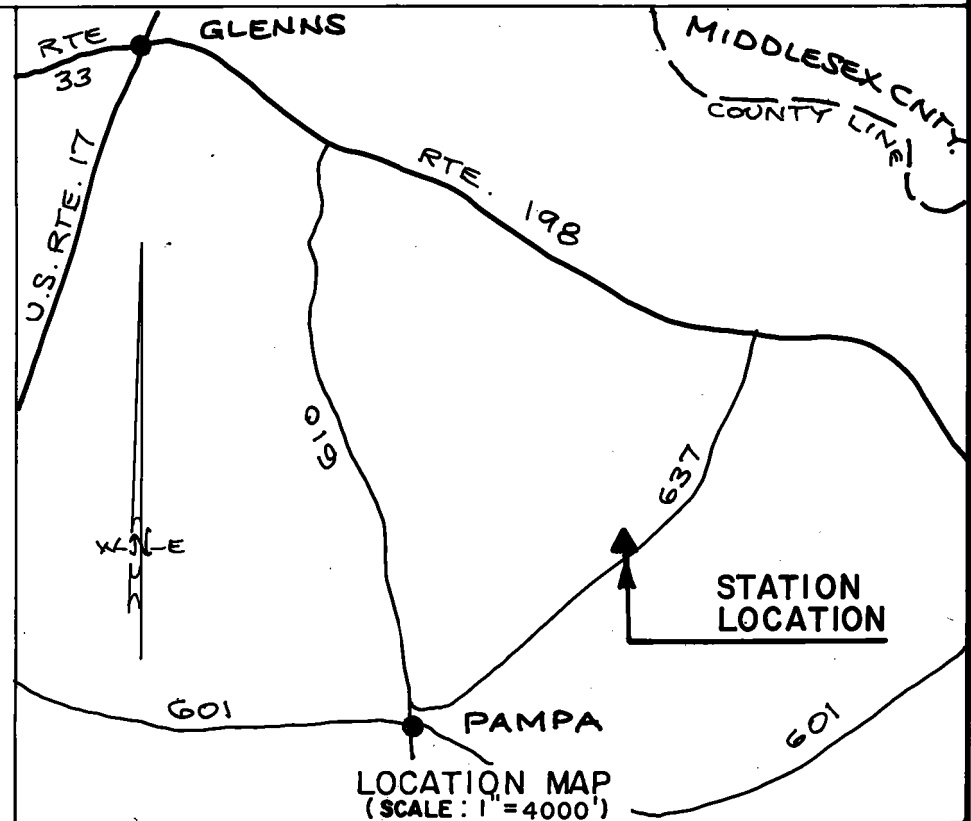

LOCATION MAP
(SCALE: 1"=4000')

DATE: JANUARY, 1992

NOTE: USERS OF MONUMENTS LOCATED ON PRIVATE PROPERTY
MUST OBTAIN LAND OWNERS PERMISSION BEFORE ENTERING



DAWSON & PHILLIPS, P.C.
CERTIFIED LAND SURVEYORS
(804) 693-2993