

# GLOUCESTER COUNTY SURVEY MARK DATA SHEET

**STATION NO.**  
013

HORIZONTAL DATA :		
VA. STATE PLANE COORD. - SOUTH ZONE (NAD 1983)		
UNITS	EASTING (X)	NORTHING (Y)
METERS	3666580.219	1134018.375
U.S. SURVEY FT.	12029438.602	3720525.285
LATITUDE (DMS)		37 31 33.55823
LONGITUDE (DMS)		76 36 54.99496
SCALE FACTOR		0.99994921
CONVERGENCE $\sphericalangle$ (DMS)		1 8 37.99
VERTICAL DATA :		
REF. TO NATL. GEOD. VERT. DATUM (1988)		
UNITS	STATION ELEVATION	
METERS	38.67	
U.S. SURVEY FT.	126.85	

**STATION DESCRIPTION :**

**DISTRICT :** PETSWORTH

A 3-1/4" ALUMINUM DISK MONUMENT SET APPROXIMATELY FLUSH WITH THE GROUND STAMPED STATION NO. 013. TO REACH: FROM THE INTERSECTION OF STATE ROUTE 601 AND STATE ROUTE 610 AT PAMPA, GO ABOUT 1.2 MILES WEST ON STATE ROUTE 601 TO MONUMENT SITE ON NORTH SIDE OF STATE ROUTE 601.

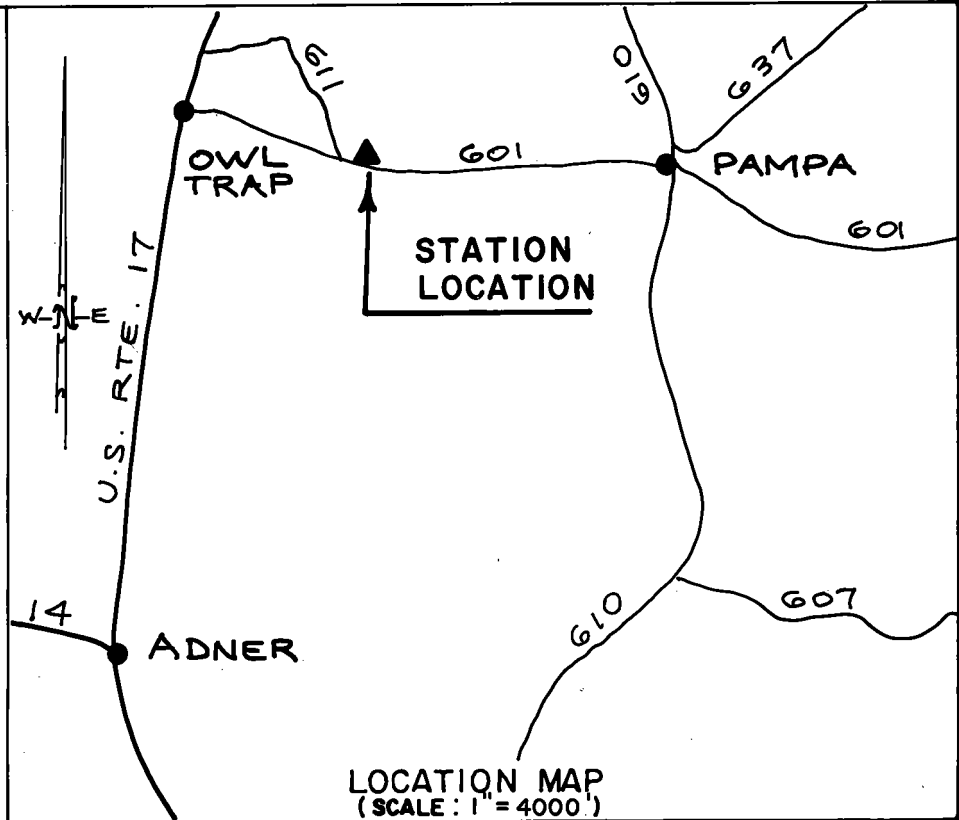
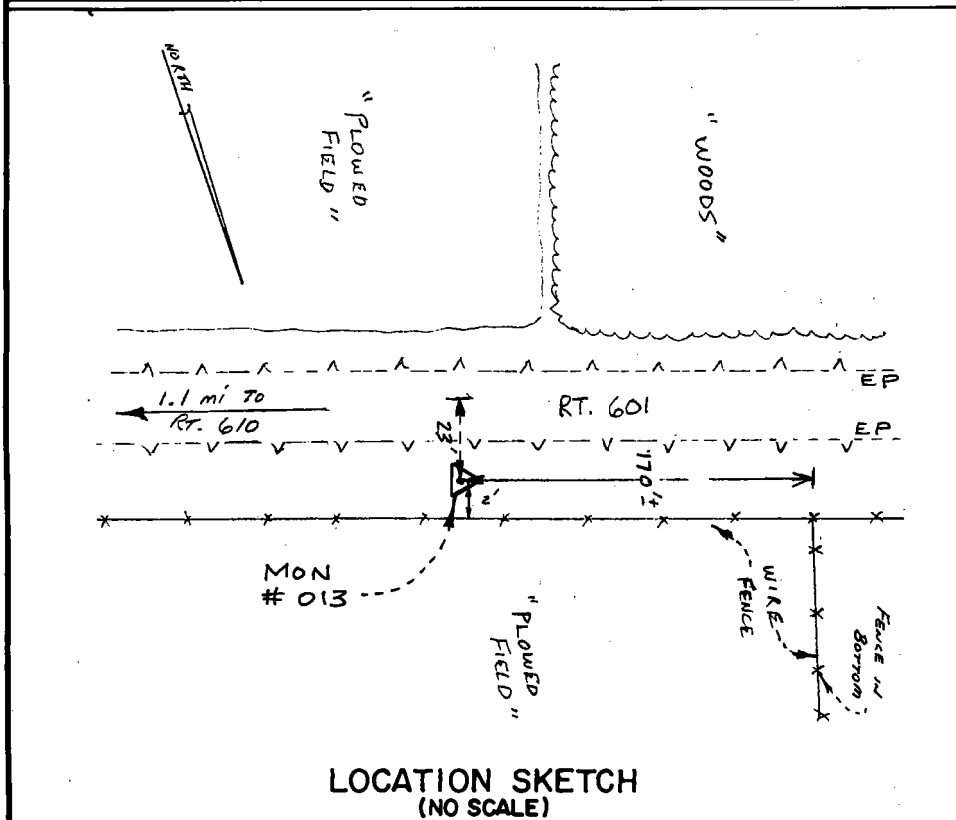

DATE: JANUARY, 1992

NOTE: USERS OF MONUMENTS LOCATED ON PRIVATE PROPERTY  
MUST OBTAIN LAND OWNERS PERMISSION BEFORE ENTERING



**Dawson & Phillips, P.C.**  
CERTIFIED LAND SURVEYORS  
(604) 693-2993